

**TISHK INTERNATIONAL UNIVERSITY  
FACULTY OF ENGINEERING  
CIVIL ENGINEERING DEPARTMENT**



# **Architecture For Civil Engineering**

**TOPIC: Lecture 3**

**Wall Bearing System ( Roof, Top Roof & Site Plan)**

**3rd Grade- Fall Semester 2020**

**Instructor: Muhammad Rojnamachy**

# - Roof & Top Roof Plan

- A **Roof plan** is a scaled drawing or diagram of a proposed **roof** development containing dimensions of the entire **roof** structure, including shape, size, design and placement of all materials, ventilation, drainage, slopes and more.
- While the **Top Roof** is the same concept of **Roof Floor Plan** but without any section line, that's mean all the drawing element are as an elevation

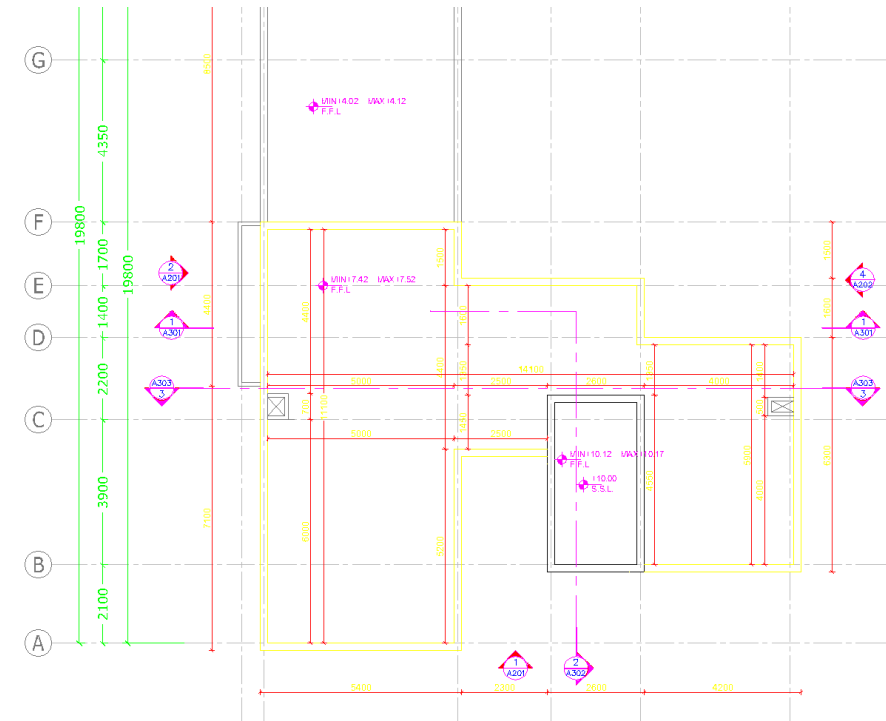
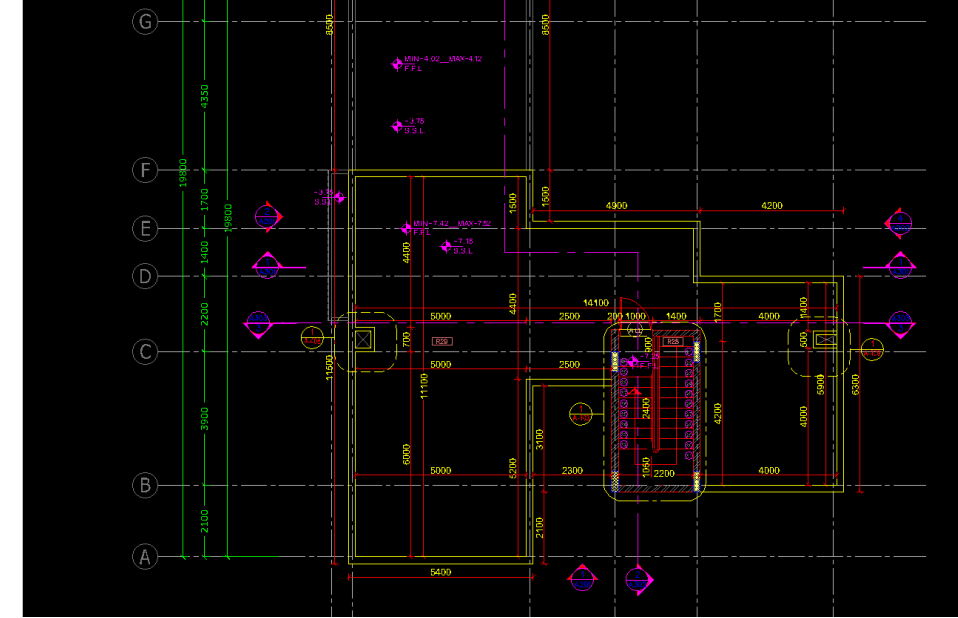

# 1-Drawing Elements of Plan

1- Main Masonry (Walls & Parapet )

2- The Openings (Doors ,Windows ....

3- Figures & Lines ( Hidden , Elevations, Steps)

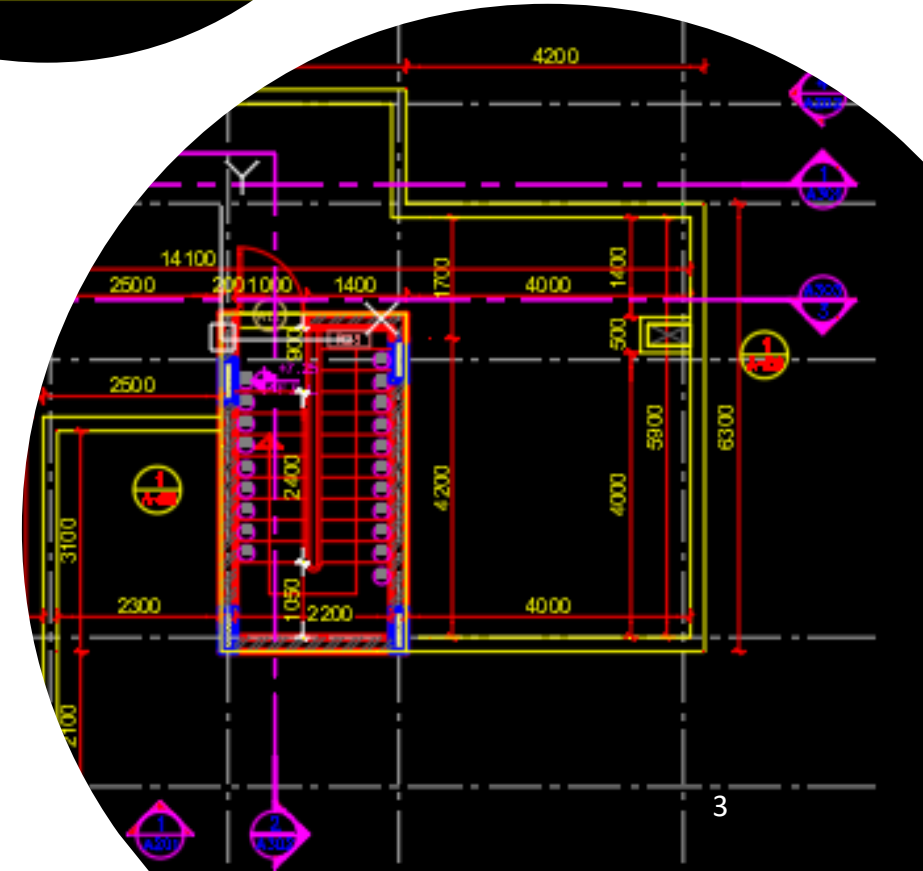
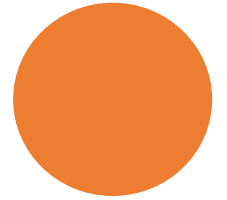
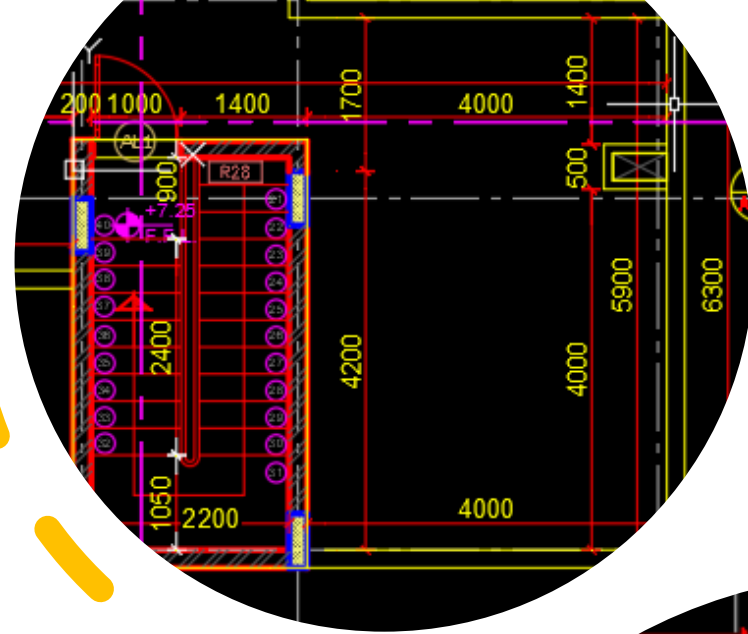

4- Axes (Grid) Lines

5- Dimensions ( Different categories)

6- Hatches (Different Styles)

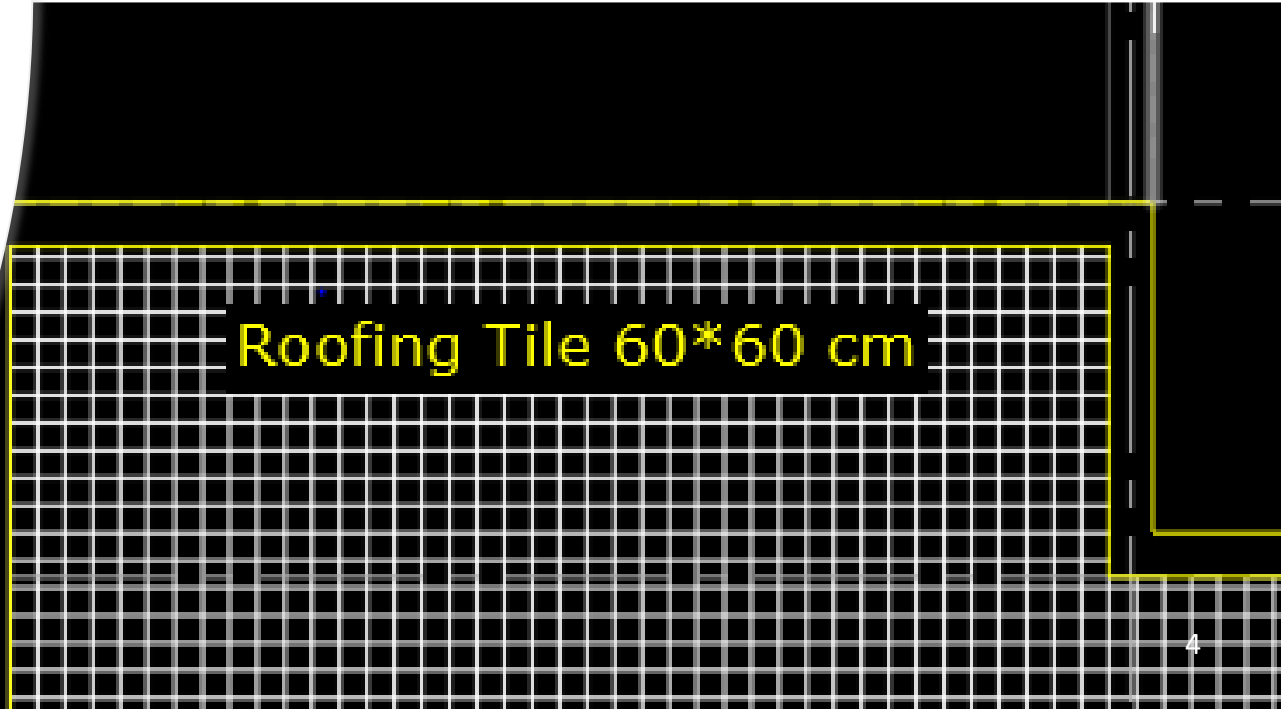
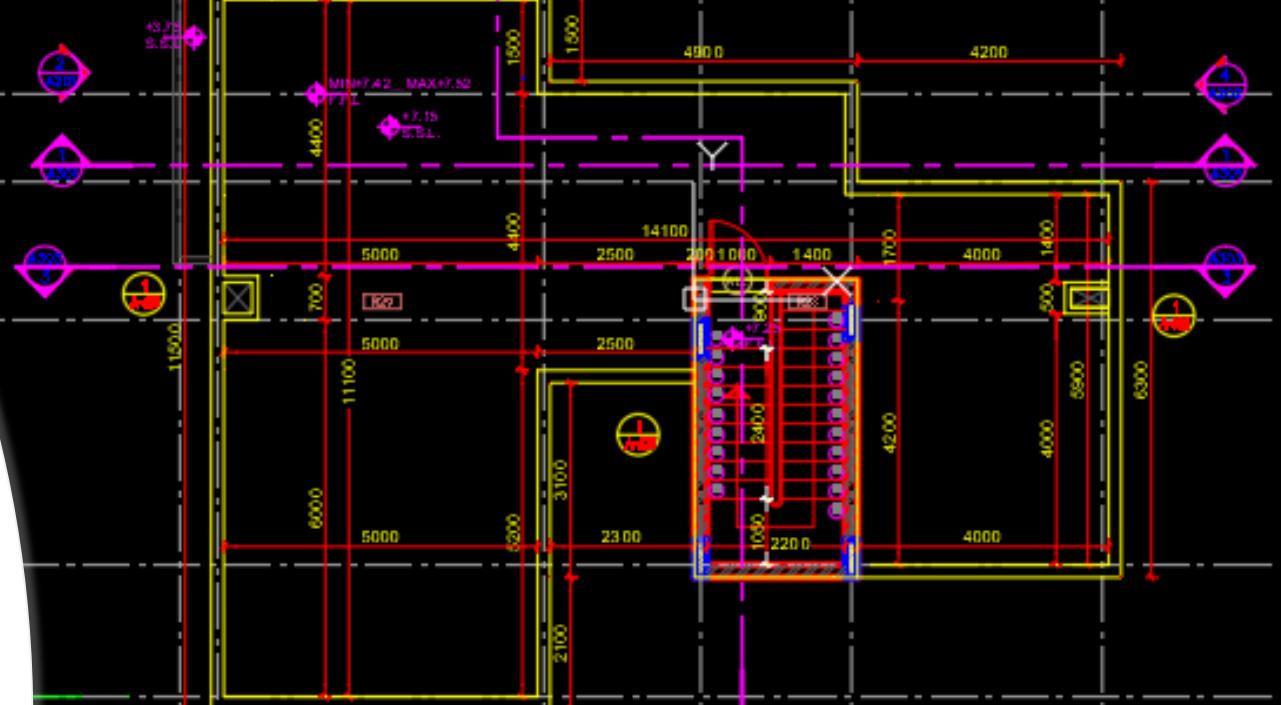

7-Tags (Windows , Doors , Details ,....

8-Levels

9- Texts ( Space Names , Directions ,  
Remarks, Notes

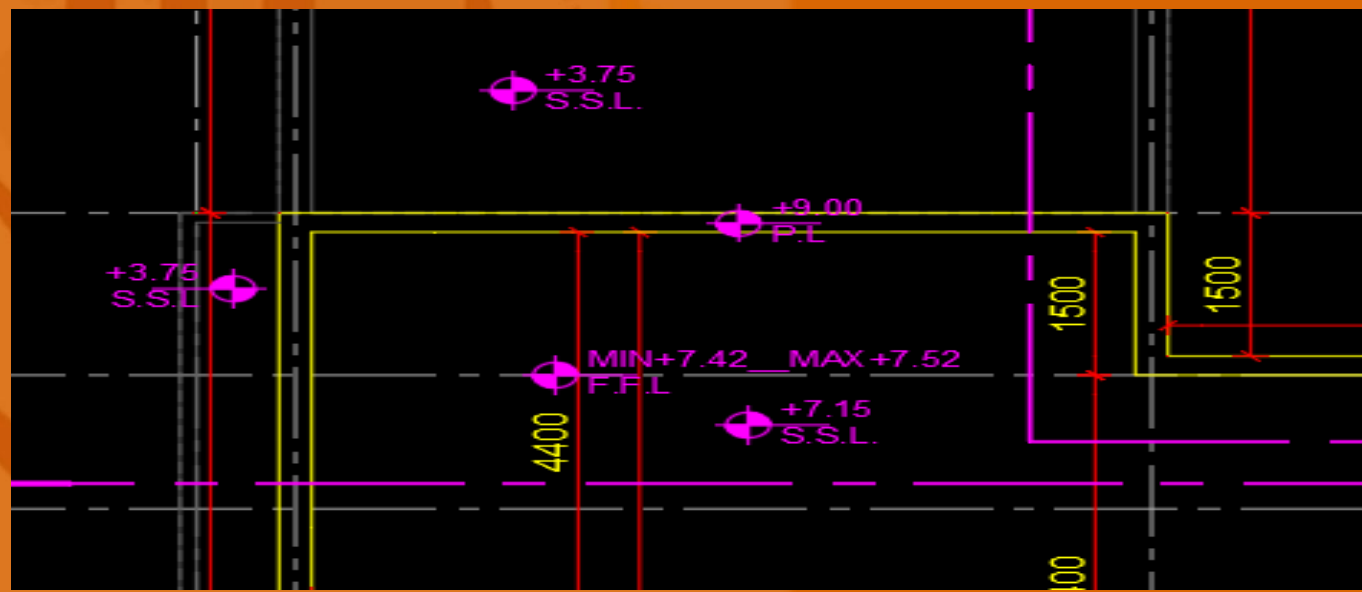
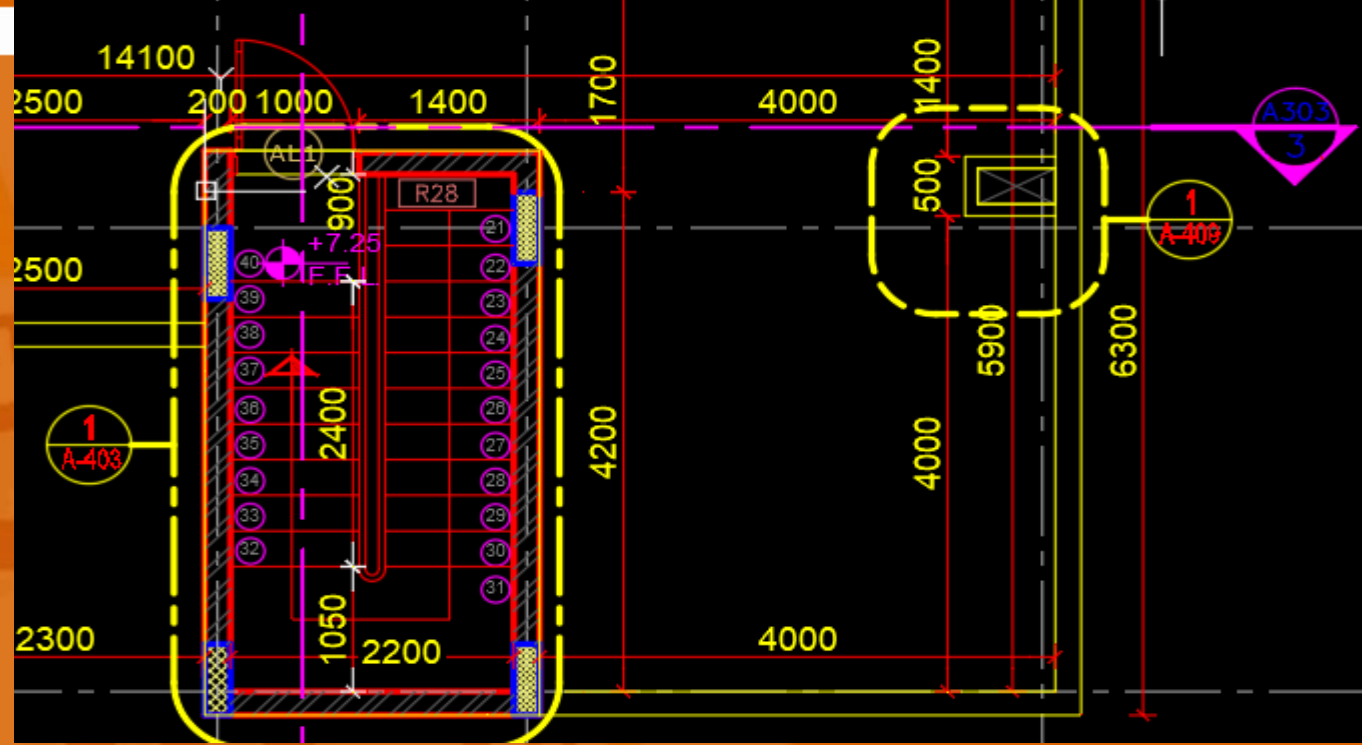
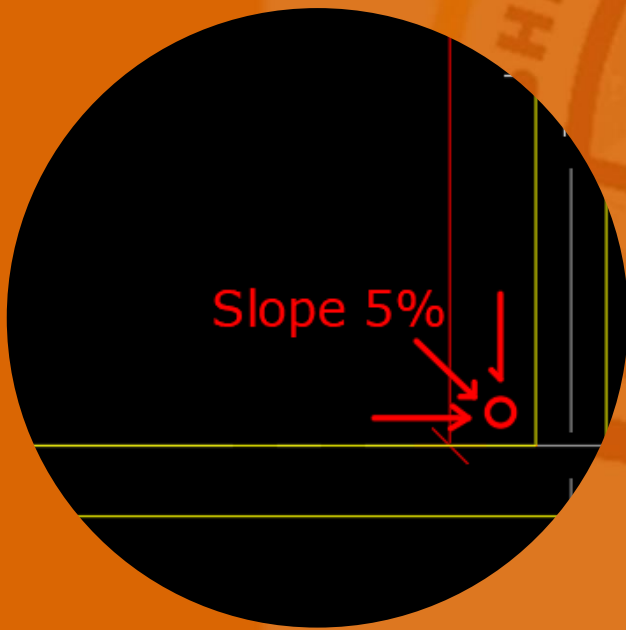

# 2- Drawing Properties

1- Line Type ( Continuous, Dashed ,  
Hidden .....

2- Line Color ( Blue, Red, Green,.....

3- Line Weight 0.00,0.05, 0.09.....



# -Site Plan

- The architectural site plan shows features of the site that are of architectural importance, as opposed to features that would be important for landscaping or grading purposes.
- Also included would be engineering features that would have an architectural impact, such as transformers, exterior lighting, fire stations.....

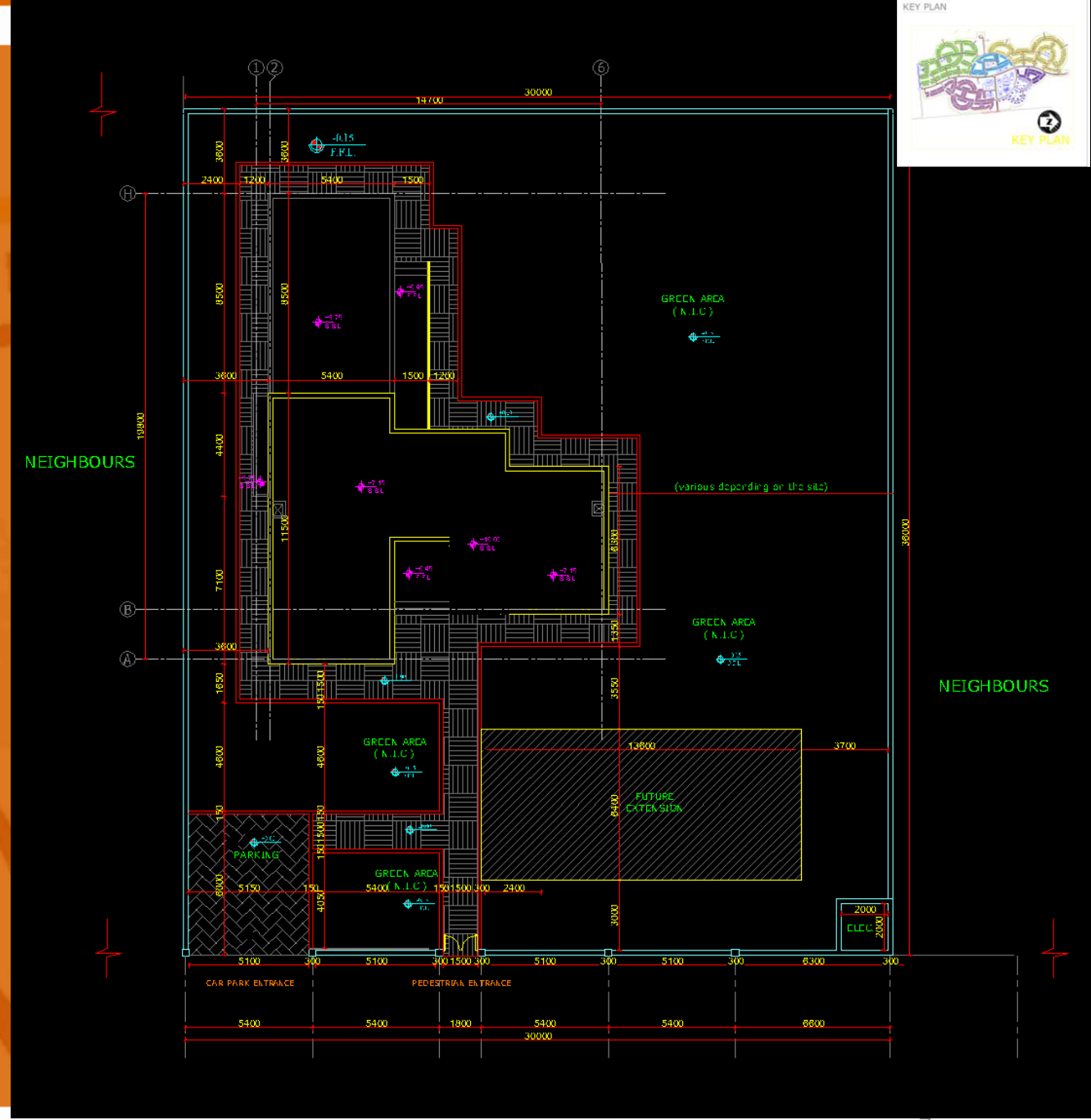

The background features a large, faint watermark of the Tishk International University logo. The logo is circular with a sunburst border. Inside the circle, the text "TISHK INTERNATIONAL UNIVERSITY" is written along the top arc, and "TIU" is written in large, bold letters in the center. Below the circle, the text "SULAIMANI" is on the left and "2014" is on the right. At the bottom of the logo is a stylized fountain pen nib. The entire background is a solid orange color.

Thank you